

Storm 3 SIM Card Replacement

BROWSER-BASED SOLUTION FOR DEPENDABLE DATA LOGGING

The **Storm 3 Data Logger** is a mid-range data logger with an ideal cost-to-performance ratio. Communicate through GOES satellite and cellular modems using a balanced set of inputs for analog, digital I/O and SDI-12 smart sensors.

YSI technical experts understand that a situation may arise where you would like to replace the existing SIM card with a card from a local carrier. Replacing the SIM card may sound simple in theory, but many steps have to be taken to access, replace, and put the Storm 3 back in working order. This technical note serves to explain this process.

Materials Required:

- Screw Driver
- Replacement SIM Card

To ensure the SIM card is replaced correctly, the following steps should be taken:

1

Remove the 4 screws from the mounting plate on the bottom of the Storm 3 (Figure 1), as well as the plate and rubber gasket (Figure 2).

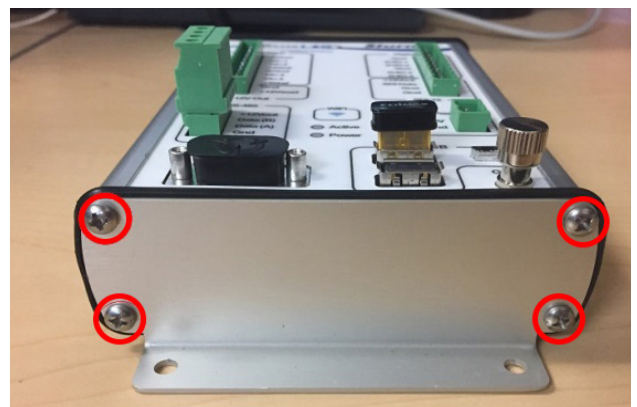

Figure 1: Bottom plate of the Storm 3 data logger showing the 4 screws



Figure 2: Bottom plate and four screws removed



2

Remove the 4 Phillips screws from the top mounting plate, and pull the plate away from Storm3—but only by a few inches (Figure 3).

Note: Take care as there is a cable for the antenna attached to the top plate so it cannot be pulled too far away or the cable could be damaged.

Once the plate is pulled away, slide the rubber gasket down the cable so that it is loose from the main case.



Figure 3: Showing plate with antenna attached, and the rubber gasket

3

Separate the two halves of the main Storm 3 case by carefully pulling them apart (Figure 4).



Figure 4: Storm 3 case separated

4

Locate the SIM card on the green modem board just above where the antenna cable connects to the board (Figure 5).



Figure 5: SIM card location on modem board



Figure 6: Replacing the SIM card with one from your own local carrier

- 5 If you need to replace the SIM card with a SIM card for your own local carrier you can slide the SIM card up gently to remove it from the holder. Insert a new SIM card by placing it with the contacts facing the modem board with the angled notch on the SIM facing the upper left hand corner (Figure 6).

- 6 Begin reassembly by placing back half of case onto the front case. Take care to move the antenna cable back up to the top opening of the case so that it does not get pinched (Figure 9).



Figure 7: Begin reassembly of Storm 3

- 7 Slide rubber gasket into place (Figure 8) then slide top mounting plate in place lining up the 4 screw holes with the holes in the case. Insert the 4 screws and start them but do not tighten them all the way yet. If screws are too tight you will have trouble lining up the screws for the bottom plate in the next step.



Figure 8: Slide rubber gasket into place

8 Flip the Storm over and place the rubber gasket on the bottom side into place (Figure 9).



Figure 9: Place rubber gasket onto bottom

9 Place bottom mounting plate into place lining up the screw holes with the holes in the main case (Figure 10).

Insert the 4 screws and tighten until snug.



Figure 10: Bottom mounting plate lining up with the holes

10 Finish tightening the 4 screws holding the top mounting plate in place and the reassembly is complete.

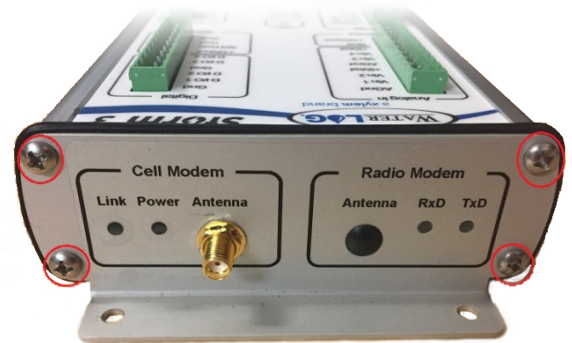

YSI, a Xylem brand
 1725 Brannum Lane
 Yellow Springs, OH 45387

+1.937.767.7241
 info@ysi.com
 YSI.com



YSI.com/Storm3